

H:\Projects\41310 Wisbech\Deliver Stage\Design\Technical\Data\Transport\Access schemes\41310-WOOD-XX-XX-DR-OT-0016\_S0\_P06.dwg Originator: ADAM.GUY

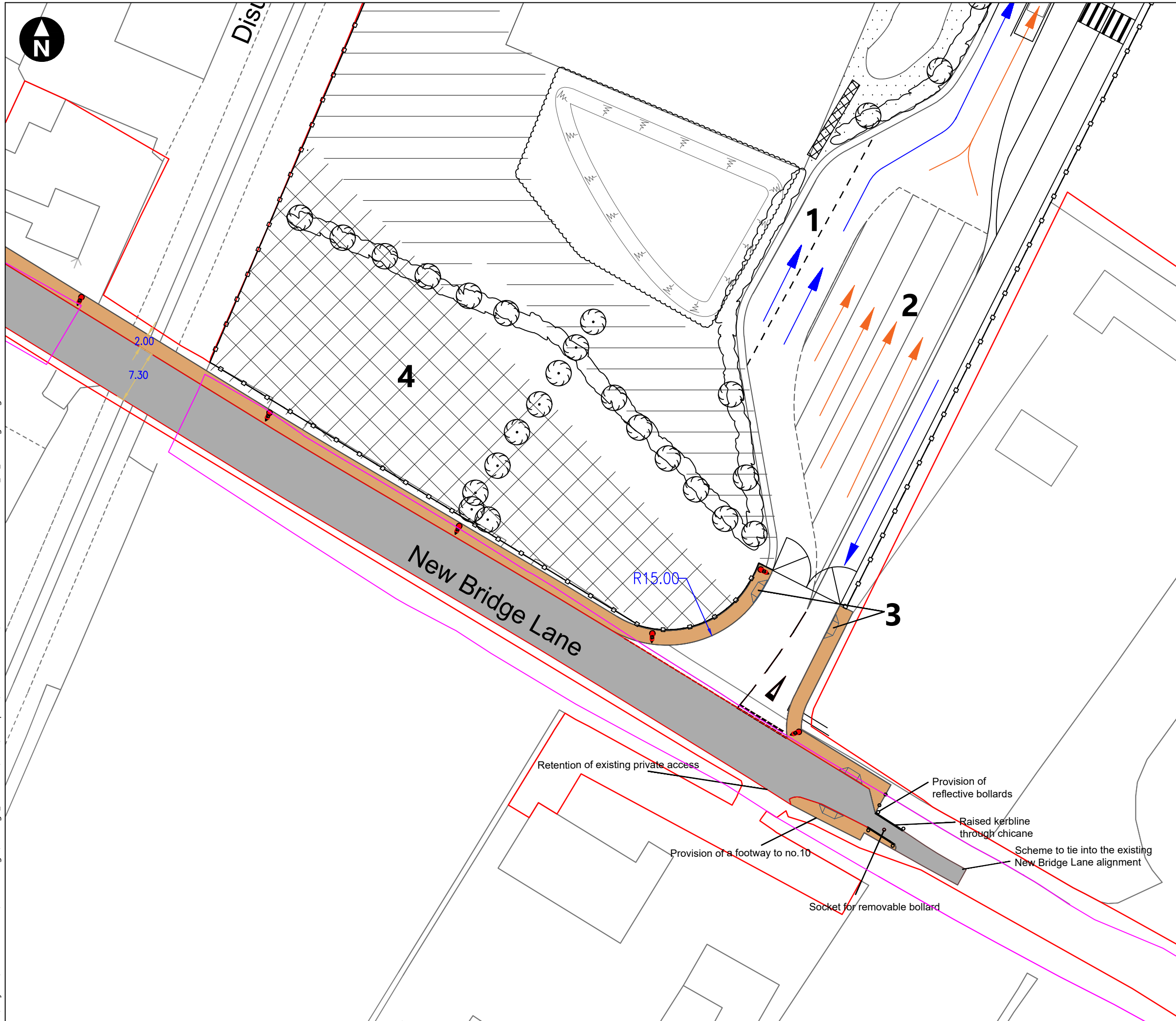

- Key**
- Order limits
  - Proposed access scheme
  - Highways boundary
  - Indicative new street lighting
  - Existing street lighting
  - Layby
  - Vehicle queuing area
  - Dropped kerb crossing
  - Rail embankment (by others) reservation area

- Notes:**
1. Proposed visibility based on New Bridge Lane being subject to a revised 30mph speed limit.
  2. Visibility requirements 2.4m x 70m, desirable minimum.
  3. New street lighting has been provided on an indicative basis (at 30m intervals and at conflict areas) and will require detailed design and assessment.
  4. Access for No.10 New Bridge Lane through a chicane; subject to the agreement of the Highways Authority. Socket for removable bollard provided and if experienced, a bollard may be installed by the highways authority to prevent through traffic.

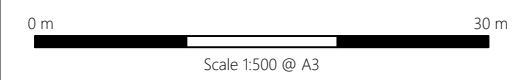

© Crown copyright. All rights reserved. Licence number AL100001776.

Medworth CHP Limited  
 Medworth Energy from Waste Combined Heat and Power Facility DCO  
 Environmental Statement  
 Chapter 6 - Traffic and Transport

**Figure 3.19i**  
**New Bridge Lane access proposal**

March 2023



H:\Projects\41310 Wisbech\Deliver Stage\Design\Technical\Data\Transport\Access schemes\41310-WOOD-XX-XX-DR-OT-0016\_S0\_P06.dwg Originator: ADAM.GUY

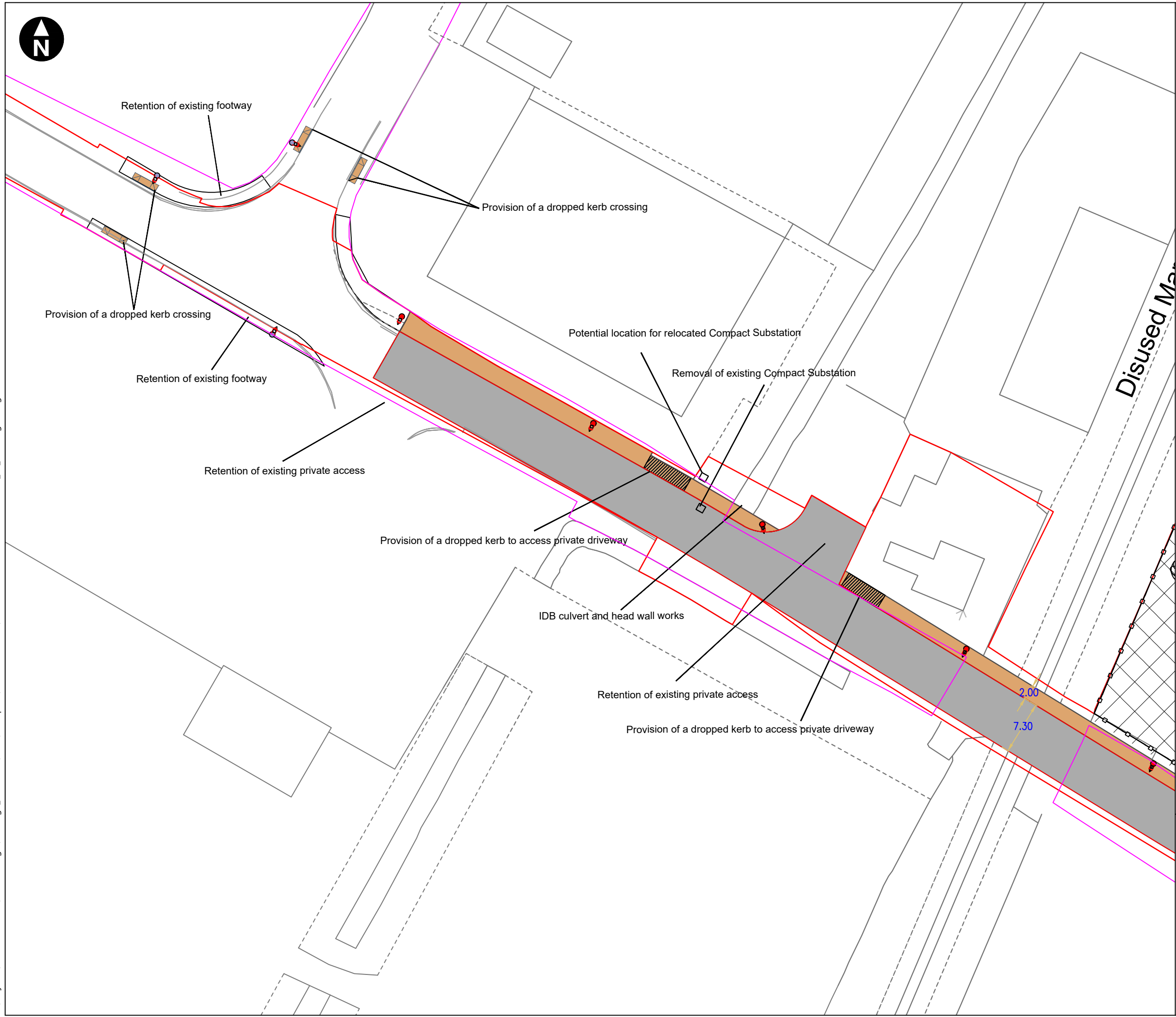

Key

- Order limits
- Proposed access scheme
- Highways boundary
- Indicative new street lighting
- Existing street lighting

- Notes:
1. New street lighting has been provided on an indicative basis (at 30m intervals and at conflict areas) and will require detailed design and assessment.
  2. Compact substation to be relocated within Order limits.
  3. Works to IDB drain either to a) replace culvert/headwall; or b) extend existing culvert and provide new headwall. See Figure 3.18 for general arrangements.



© Crown copyright. All rights reserved. Licence number AL100001776.

Medworth CHP Limited  
 Medworth Energy from Waste Combined  
 Heat and Power Facility DCO  
 Environmental Statement  
 Chapter 6 - Traffic and Transport

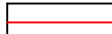
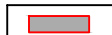
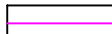

**Figure 3.19ii**  
**New Bridge Lane access proposal**

March 2023





Key

-  Order limits
-  Proposed access scheme
-  Highways boundary
-  Indicative new street lighting
-  Existing street lighting

- Notes:
1. Proposed visibility based on New Bridge Lane being subject to a revised 30mph speed limit.
  2. New street lighting has been provided on an indicative basis (at 30m intervals and at conflict areas) and will require detailed design and assessment.



© Crown copyright. All rights reserved. Licence number AL100001776.

Medworth CHP Limited  
 Medworth Energy from Waste Combined Heat and Power Facility DCO  
 Environmental Statement  
 Chapter 6 - Traffic and Transport

**Figure 3.19iii**  
**New Bridge Lane access proposal**

March 2023



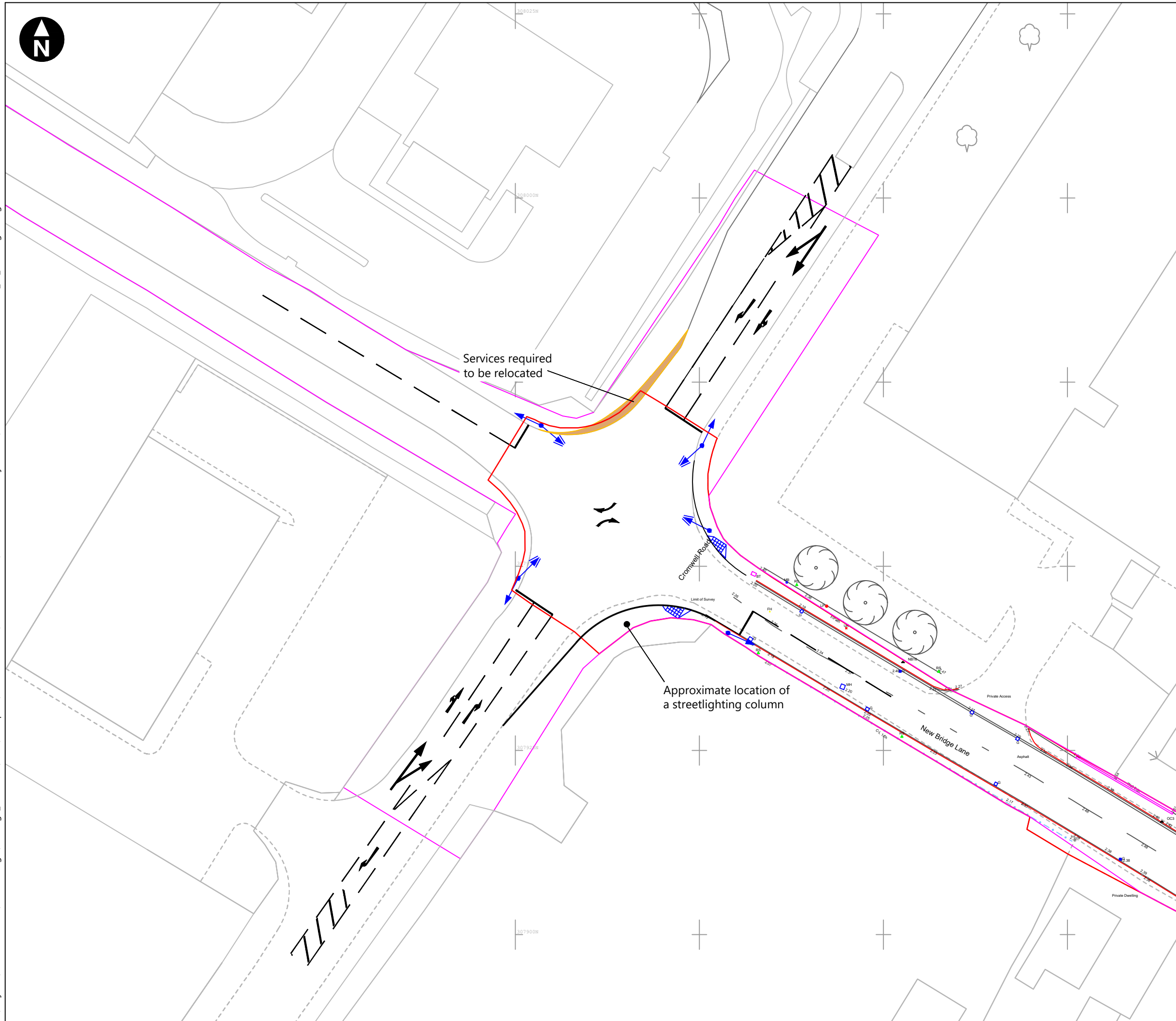

Key

- Order limits
- Highways boundary
- Primary signal head
- Secondary signal head
- Indicative road marking scheme
- Kerb realignment for HGV movements

- Notes:
1. Newbridge lane Topographical Survey undertaken by MFM Land Surveys and Engineering Services Ltd between 6-9 November 2019.
  2. Outside the extents of the topographical survey this scheme has been developed using OS basemapping.
  3. Road markings are based on guidance within chapters 5 and 6 of the Traffic Signs Manual, 2019.



© Crown copyright. All rights reserved. Licence number AL100001776.

Medworth CHP Limited  
 Medworth Energy from Waste Combined Heat and Power Facility DCO  
 Environmental Statement  
 Chapter 6 - Traffic and Transport

**Figure 3.19iv**  
**Cromwell Road/New Bridge Lane Signal Scheme - General arrangement**

March 2023

